

796381 -2 Product Details

Live Product Chat US Only
8:30am - 5pm ET, Mon - Fri

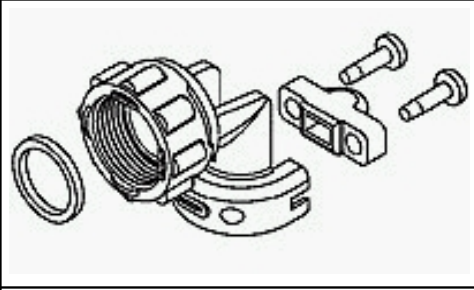

796381 -2

[Active](#)

CPC Accessories

[Always EU RoHS/ELV Compliant](#) ([Statement of Compliance](#))

Product Highlights:

- ? Cable Clamp
- ? Shell Size = 17
- ? Body Style = Right Angle
- ? Cable Diameter (Max.) = 11.51 mm
- ? Nylon Cable Clamp Material

[View all Features](#) | [Find Similar Products](#)

Quick Links

- [Check Pricing & Availability](#)
- [Search for Tooling Product Feature Selector](#)
- [Contact Us About This Product](#)

Documentation & Additional Information

Product Drawings:

- ? [CABLE CLAMP KIT, UNASSEMBLED, RIGHT ANGLE, SIZE 17, CPC](#) (PDF, English)

Catalog Pages/Data Sheets:

- ? None Available

Product Specifications:

- ? None Available

Application Specifications:

- ? None Available

Instruction Sheets:

- ? None Available

CAD Files: ([CAD Format & Compression Information](#))

- ? [2D Drawing](#) (DXF, Version A1)
- ? [3D Model](#) (IGES, Version A1)
- ? [3D Model](#) (STEP, Version A1)

[List all Documents](#)

Additional Information:

- ? [Product Line Information](#)

Additional Product Images:

- ? [Product Usage](#)
- ? [Product Usage](#)
- ? [Product Usage](#)

Related Products:

- ? [Tooling](#)

Product Features (Please use the Product Drawing for all design activity)

Product Type Features:

- ? [Product Type](#) = Cable Clamp
- ? [Shell Size](#) = 17
- ? [Body Style](#) = Right Angle
- ? Screw Size = 5 -20 Self -Tapping

Body Related Features:

- ? [Cable Diameter \(Max.\) \(mm \[in\]\)](#) = 11.51 [0.453]
- ? [Cable Clamp Material](#) = Nylon
- ? [Cover](#) = Without
- ? Cable Clamp Color = Black
- ? Cable Clamp Flammability Rating = UL94V -0

Industry Standards:

- ? [RoHS/ELV Compliance](#) = RoHS compliant, ELV compliant
- ? [Lead Free Solder Processes](#) = Not relevant for lead free process
- ? RoHS/ELV Compliance History = Always was RoHS compliant

Packaging Related Features:

- ? [Packaging Method](#) = Individual

Other:

- ? Brand = AMP